

LR05CW

Remote Sensors

Standard, Remote Photoelectric Systems



Product Data	
Function:	Receiver
Housing Material:	Nickel Plated Brass
Housing:	M12 x 1
Connection:	15 meter cable
Sensing Range:	Up to 40 m
Optical Angle:	+/- 3° (opening)
Indicators:	Yes

Technical Data	
Photo Transistor:	Silicon NPN
Power On Indicator:	-
Output Indicator:	-
Light Source:	-
Cable:	2 x 0,25 mm ²
Housing Material Sensor Housing:	Nickel Plated Brass
Housing Material Lens Cover:	Polycarbonate
Transmitter Diode:	-
Cable Sleeve:	PVC Ø 4,0 mm
Min. Cable Bending Radius:	45 mm

Environmental Data	
Vibration:	10 – 55 Hz 0,5 mm
Shock:	30 g
Operation Temperature:	-25 to +65° C
Storage Temperature:	-40 to +80° C
Sealing Class:	IP 67
Light Immunity 20°:	> 100,000 lux

Approvals



Wiring Diagram

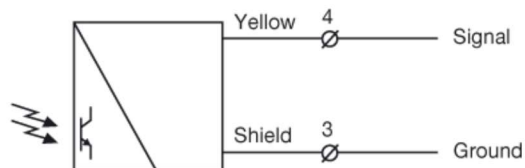

Dimensions

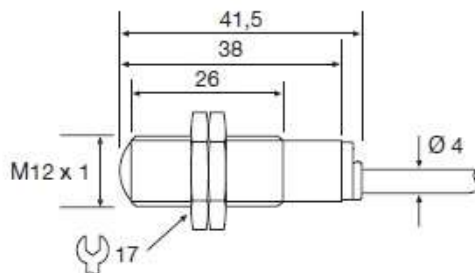

Sensing Characteristics

Parallel Displacement

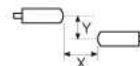
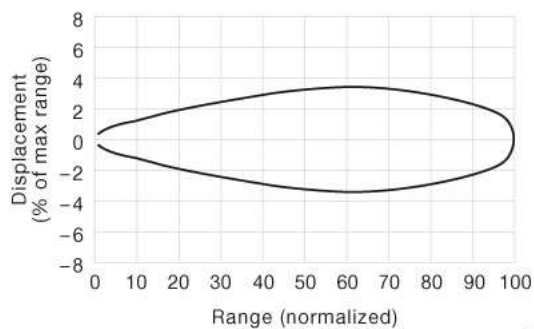

Angular Displacement

